



Manor Walk

Hanging Houghton, Northamptonshire

oriordanbond
SALES & LETTINGS



Manor Walk

Hanging Houghton
NN6 9EP

Price
£399,995

- Extended Mature Village Home
- Large Private Corner Plot
- Refitted Kitchen/Family/Dining room
- Three Well Proportioned Bedrooms
- Refitted Bathroom With Shower/bath
- Stunning Views Over Countryside





GROUND FLOOR
743 sq.ft. (69.1 sq.m.) approx.

1ST FLOOR
444 sq.ft. (41.2 sq.m.) approx.

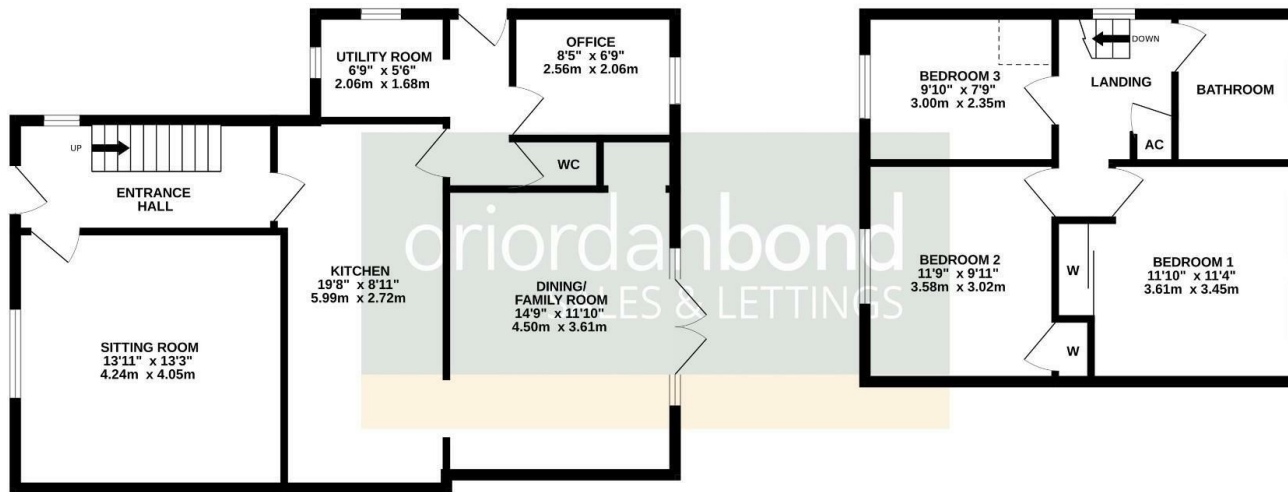

TOTAL FLOOR AREA : 1188sq.ft. (110.4 sq.m.) approx.

Whilst every attempt has been made to ensure the accuracy of the floorplan contained here, measurements of doors, windows, rooms and any other items are approximate and no responsibility is taken for any error, omission or mis-statement. This plan is for illustrative purposes only and should be used as such by any prospective purchaser. The services, systems and appliances shown have not been tested and no guarantee as to their operability or efficiency can be given.
Made with Metropix ©2025



Additional information

- Council Tax Band: B
- Energy Efficiency Rating: D

Viewing

Viewing strictly by appointment – details below

Disclaimer

O'Riordan Bond Estate Agents Limited has not tested apparatus, equipment, fittings or services and so cannot verify they are in working order. The buyer is advised to obtain verification from their solicitor or surveyor.

O'Riordan Bond Brixworth Sales

01604 880077

brixworth@oriordanbond.co.uk

